

Tuscan *Spirit*

Tuscan Spirit

---



---

TUSCAN SPIRIT - HANSE YACHT



# Tuscan Spirit

---



---

TUSCAN SPIRIT - HANSE YACHT



# Tuscan Spirit

---



---

TUSCAN SPIRIT - HANSE YACHT

# Tuscan Spirit



Every detail of this 19m sailing yacht has been intricately planned by renowned Florence-based architecture and design firm, Prima Design.

As her name suggests, **TUSCAN SPIRIT** has been projected to transmit the very essence of the region it hails from.

In a luxurious & casual atmosphere, the boat comfortably sleeps six guests in three spacious bedrooms with plenty of storage place, along with three full-size bathrooms.

Expansive and elegantly-appointed entertaining spaces both inside and out allow for Guests to experience a refined lifestyle wherever **TUSCAN SPIRIT** may sail.



# Tuscan Spirit

---



---

SALOON

TUSCAN SPIRIT - HANSE YACHT



# Tuscan Spirit



SALOON



TUSCAN SPIRIT - HANSE YACHT



# Tuscan Spirit

---



MASTER CABIN



TUSCAN SPIRIT - HANSE YACHT



# Tuscan Spirit

---



GUEST CABINS



TUSCAN SPIRIT - HANSE YACHT





## KEY FEATURES

- 1 Excellent performances under sails
- 2 Mast and Boom in carbon fiber
- 3 Amazing Captain Sailing Instructor
- 4 Tender mt 3.60 with rigid keel



# Tuscan Spirit

## ACCOMODATIONS

Up to 6 guests in 3 ensuite cabins  
2 Double cabins  
1 Twin/Double convertible cabin  
TV in each cabin

## EQUIPMENTS

Air conditioning, WiFi connection on board, Hi-Fi system inside and outside speakers, X BOX and APPLE TV satellite SKY in the saloon.

## TENDER & TOYS

New tender with 20hp engine, paddle board, Snorkeling sets, inflatable banana for kids.

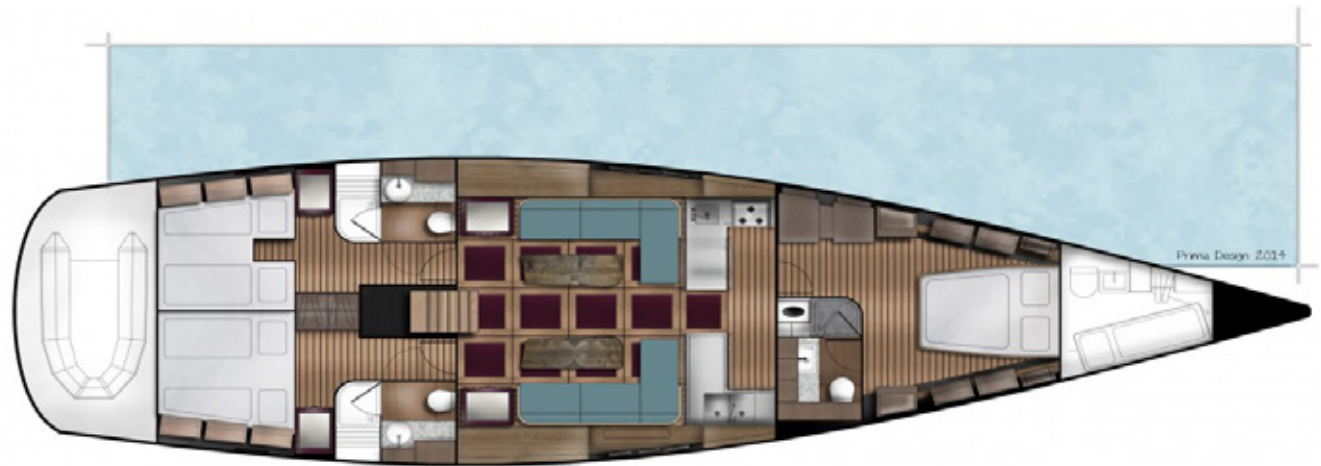

## YACHT SPECIFICATIONS

TUSCAN SPIRIT - HANSE YACHT

# Tuscan Spirit

BUILDER: Hanse Yachts

INTERIOR DESIGN: Prima Design

YEAR BUILD: 2014

REFIT: 2022

LENGTH: 19,00 M

BEAM: 5,20 M

DRAFT: 2.95 M

CRUISING: 9 Knots

CONSUMPTION: 20 l/h

ENGINE: Volvo penta D3 150 hp

